

Conveyor System DS2

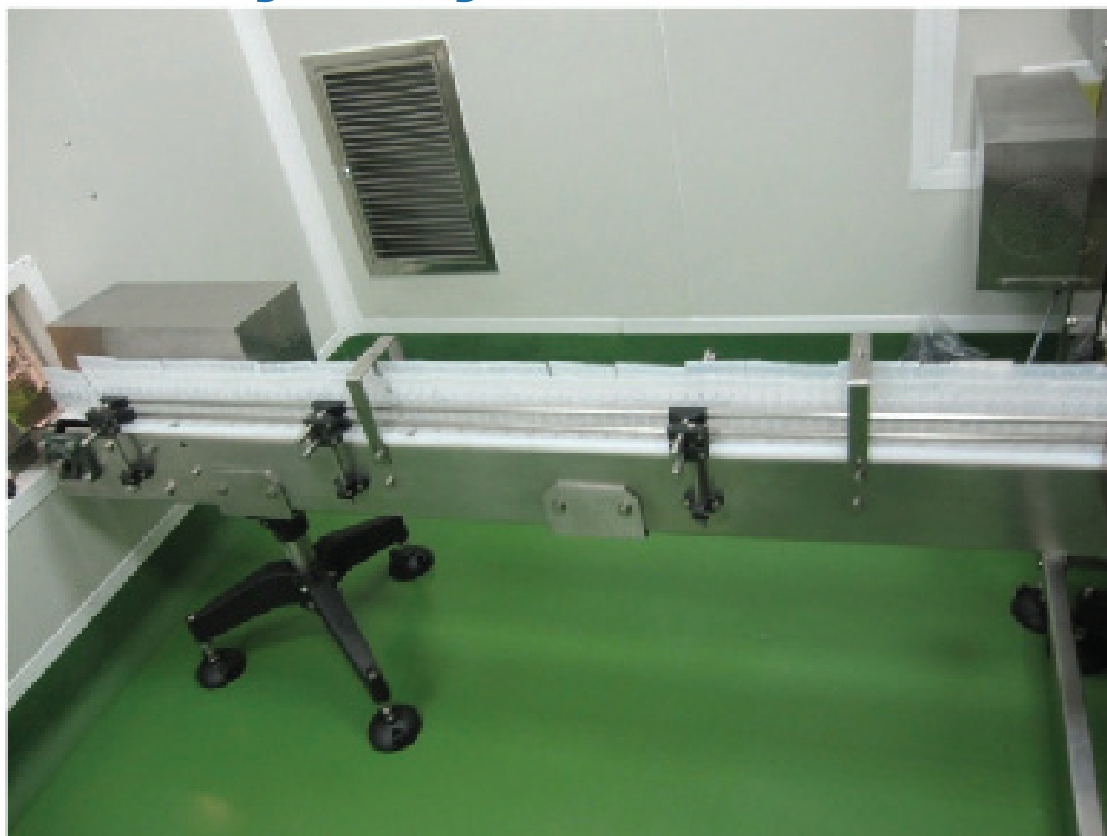

Description

63mm width thermoplastic chain with stainless steel frame conveyor system. Also available with aluminium frame, please refer section MS2.

Examples of application industries

Personal Products, Pharmaceutical & Chemical Industry, Automotive & Machined Parts Industry, Food & Packaging Industry, Electrical & Electronic Industry, Paper Converting Industry and Optical Industry

Technical characteristics

| | | |
|-------------------------------|----------------------|---------------|
| Chain Width | | 63 mm |
| Chain Pitch | | 25.4 mm |
| Chain Weight | | 0.8 kg/m |
| Chain Maximum Working Tension | | 600 N |
| Max Product Weight* | Horizontal Transport | 15 kg |
| | Vertical Transport | 10 kg |
| Total Load* | | 200 Kg |
| Working Temperature* | | -10°C to 60°C |
| Max Conveyor Length* | | 30m |
| Max Speed* | | 50 m/min |
| Drive Unit Capacity | | 600 N |
| Item Width* | | 15-140 mm |

* Actual limit may vary according to conveyor layout and application.

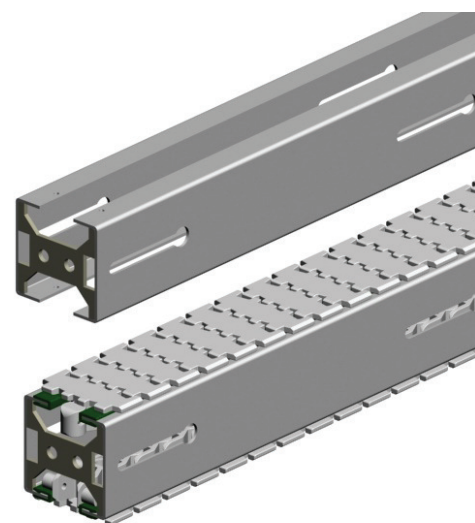

Please consult MODU representative for further information and assistance.

Units: Dimension (mm)

Chains DS2

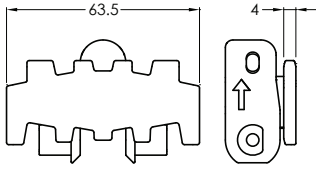

Plain Chain

- Suitable for conveyor configuration with incline/decline up to 5°.
- Accumulation possible.



| Item Code | Material | Colour | Weight | Supply |
|-----------|-------------|--------|-------------|---------|
| MS2 CP 5 | POM | White | 4.0 kg/roll | 5m/roll |
| MS2 CP 5A | Anti-Static | Black | 4.0 kg/roll | 5m/roll |
| MS2 CP 5K | POM-Kevlar | Yellow | 6.0 kg/roll | 5m/roll |

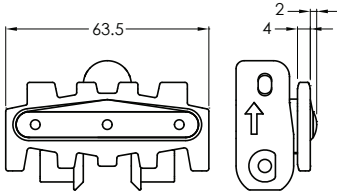

Friction Chain

- Suitable for conveyor configuration with incline/decline up to 25°.
- Friction material : TPU (grey).
- Accumulation not possible.

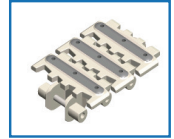

| Item Code | Material | Colour | Weight | Supply |
|-----------|-------------|--------|-------------|---------|
| MS2 CF 5 | POM | White | 4.5 kg/roll | 5m/roll |
| MS2 CF 5A | Anti-Static | Black | 4.5 kg/roll | 5m/roll |
| MS2 CF 5K | POM-Kevlar | Yellow | 6.5 kg/roll | 5m/roll |

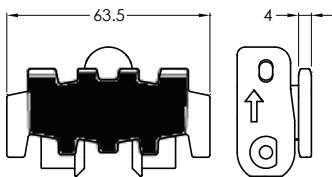

Flocked Chain

- Suitable for scratch sensitive material.
- Flock colour : Black.
- Accumulation possible for light product only.
- Sticker type only



| Item Code | Material | Colour | Weight | Supply |
|-----------|----------|--------|-------------|---------|
| MS2 CL 5 | POM | White | 4.2 kg/roll | 5m/roll |

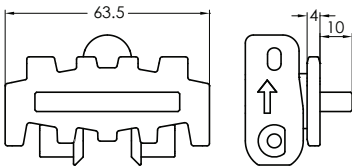

Cleated Chain - Machined PE Cleated

- Required for vertical or steeply inclined / declined conveyor.
- Accumulation not possible.
- Not suitable to be use with Combined and Catenary Drive.
- Please specify pitch between cleat for ordering (eg. MS2 CC 3x10P 3p = Every 3rd link to be cleated).
- **Please consult MODU representative for actual Chain weight.

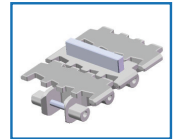

* Other cleated height are available upon request.

| Item Code | Material | Colour | Weight | Supply |
|-----------|----------|--------|------------|---------|
| MS2 CC 3 | POM | White | ** kg/roll | 3m/roll |

Chain Accessories DS2

Lubricant For Chain



Silicone-based lubricant,
400ml

| Item Code | Weight | Supply |
|-----------|---------|--------|
| MA SL | 0.35 kg | 1 pc |

Stainless Steel Pin

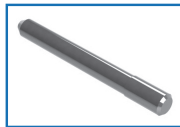

| Item Code | Weight | Supply |
|--------------|---------|------------|
| MS2 PN M4x37 | 0.07 kg | 10 pcs/pkt |

Chain Pivot



| Item Code | Weight | Supply |
|-----------|---------|------------|
| MS2 PV | 0.01 kg | 10 pcs/pkt |

Chain Pin Insertion Tool



Chain pin insertion tool shown without attachment & specific drive pin

| Item Code | Weight | Supply |
|-----------|--------|--------|
| TR CP 1 | 1.2 kg | 1 pc |

Attachment For Chain Tool

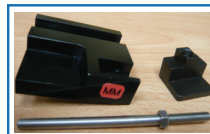

Chain attachment & drive pin

| Item Code | Weight | Supply |
|-----------|---------|--------|
| MS2 AC | 0.20 kg | 1 set |

Please consult MODU representative for further information and assistance.

Units: Dimension (mm)

Drive Units DS2

Item Code Guideline For Drive Units

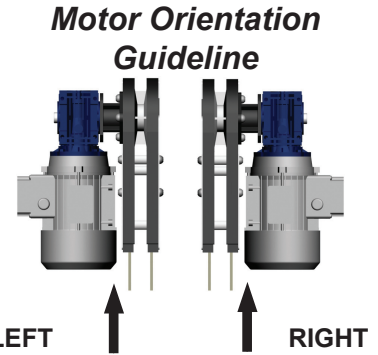
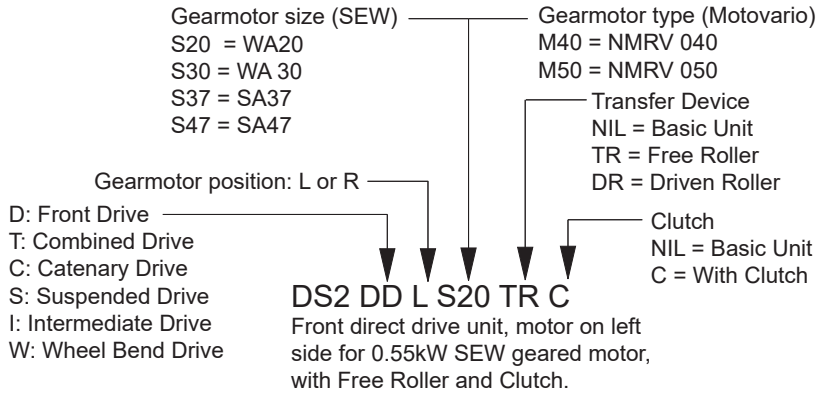

* Drive comes without gearmotor, Please refer TR-13 for gear motor options.

eg. Code for Basic unit; DS2 DT R M50 => Combined drive unit, motor on right side for Motovario NMRV 050 geared motor.

Front Drive Unit

Basic Front Drive

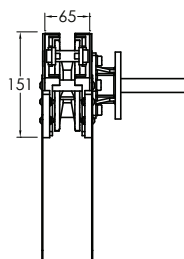
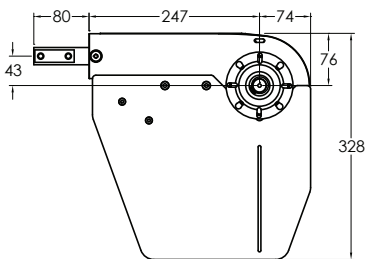

* Comes without Safety Cover

Front Drive with Free Roller

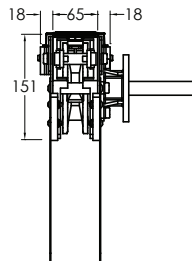
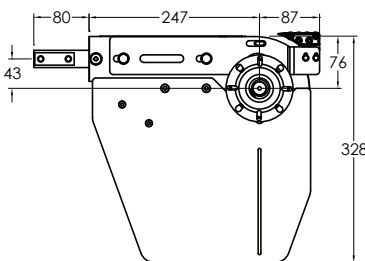

* Comes without Safety Cover

Front Drive with Driven Roller

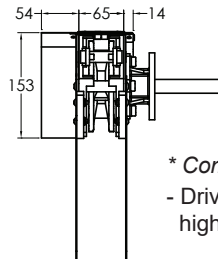
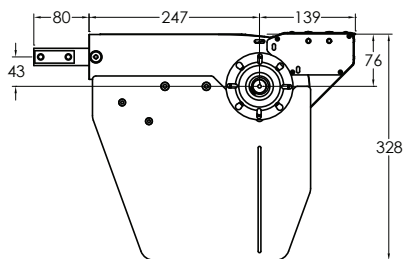

* Comes without Safety Cover
 - Driven Roller speed is approximately 10% higher than conveyor speed.

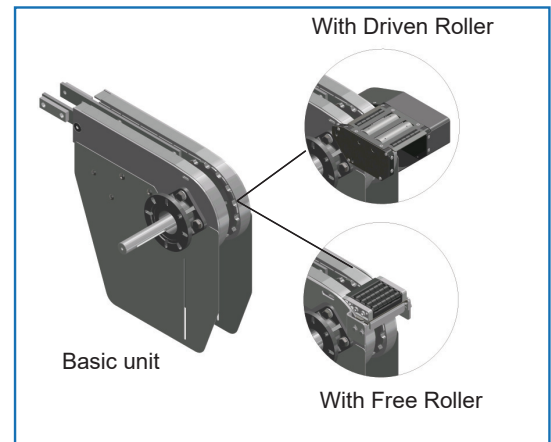

| Item Code | Weight | Supply |
|---|--------|--------|
| DS2 DD R/L S/M | 3.8 kg | 1 unit |
| DS2 DD R/L S/M TR With free roller | 4.0 kg | 1 unit |
| DS2 DD R/L S/M DR With driven roller | 5.0 kg | 1 unit |

Effective track length: 0.80m
 Traction force: 600N
 - Connecting strip and set screw included.
 Note:
 - Safety Cover comes as an option.
 - Recommended maximum chain elongation is 328mm from top conveyor to chain slack.
 - Refer TR15 for chain effective track length calculation.
 - Cleated Chain is not possible to use on drive with Free Roller or Driven Roller.

Please consult MODU representative for further information and assistance.

Units: Dimension (mm)

Drive Units DS2 (Continued)

Safety Cover for Front Drive

Short Safety Cover

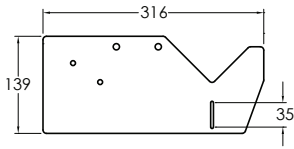

- Material : Stainless Steel

| Item Code | Weight | Supply |
|-----------|--------|-----------|
| SC 139 | 0.8 kg | 2 pcs/set |

Normal Safety Cover

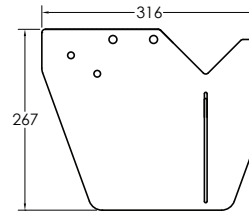

- Material : Stainless Steel

| Item Code | Weight | Supply |
|-----------|--------|-----------|
| SC 267 | 1.4 kg | 2 pcs/set |

Idler End

Basic Idler End

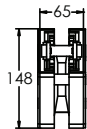
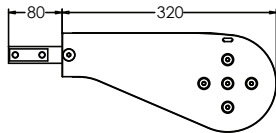

Idler End with Free Roller

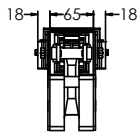
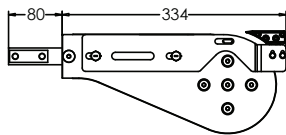

Idler End with Driven Roller *(Right)

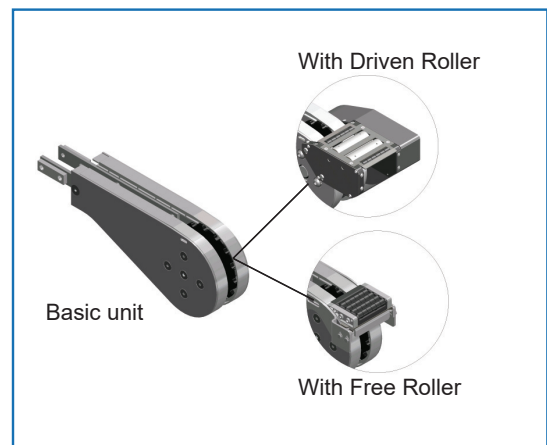
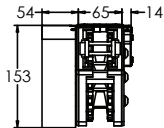
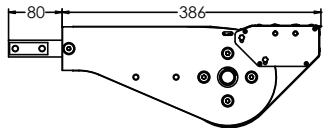

- Driven Roller speed is approximately 10% higher than conveyor speed.

| Item Code | Weight | Supply |
|-------------------------------------|--------|--------|
| DS2 IE 320 | 3.0 kg | 1 unit |
| DS2 IE 320 TR With free roller | 3.4 kg | 1 unit |
| DS2 IE 320 DR With driven roller | 4.5 kg | 1 unit |

Effective track length: 0.8m

- Connecting strip and set screw included.

Note:

- Cleated Chain not suitable for Driven Roller & Free Roller.

Conveyor Beam DS2

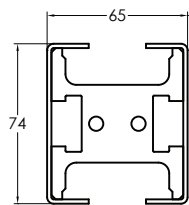

| Item Code | Weight | Supply |
|------------|--------|--------|
| DS2 CB 2.4 | 6.2 kg | 2.4 m |

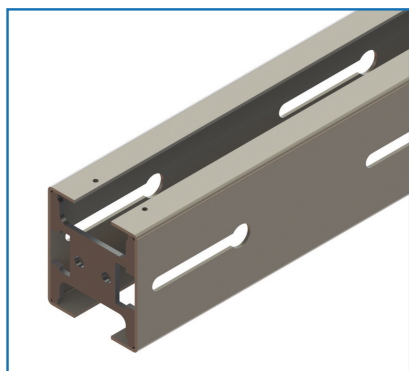

Accessories DS2

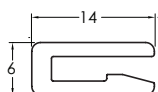

Slide Rail

| Item Code | Material | Colour | Weight | Supply |
|-----------|-------------|------------------------|-------------|----------|
| MS SR 25 | HDPE | Pure White | 1.2 kg/roll | 25m/roll |
| MS SR 25A | Anti-Static | Grey | 1.2 kg/roll | 25m/roll |
| MS SR 25U | UHMW-PE | Semi-Transparent White | 2.7 kg/roll | 25m/roll |
| MS SR 25P | PVDF | Natural White | 2.7 kg/roll | 25m/roll |

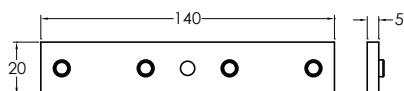

Connecting Strip

| Item Code | Weight | Supply |
|--------------|--------|------------|
| DA CS 20x140 | 1.5 kg | 10 pcs/pkt |

- 4 pcs M8 set screw included.

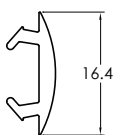

T-Slot Cover

| Item Code | Material | Colour | Weight | Supply |
|-----------|----------|------------|-------------|----------|
| MB SC 25T | TPE | Grey | 1.5 kg/roll | 25m/roll |
| MB SC 25P | PVC | Light Grey | 1.3 kg/roll | 25m/roll |



Rivets

| Item Code | Weight | Supply |
|-----------|---------|------------|
| MA RR 3 | 0.02 kg | 50 pcs/pkt |

Material: Aluminium



Slide Rail Cutter

| Item Code | Weight | Supply |
|-----------|--------|--------|
| MA SC | 0.5 kg | 1 pc |

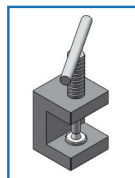

Rivet Crimping

| Item Code | Weight | Supply |
|-----------|---------|--------|
| MA RC | 0.13 kg | 1 pc |



Slide Rail Mounting Tool

| Item Code | Weight | Supply |
|-----------|--------|--------|
| MS2 SRA | 0.4 kg | 1 pc |

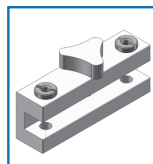

Slide Rail Drill Fixture

| Item Code | Weight | Supply |
|-----------|---------|--------|
| MA SRF | 0.24 kg | 1 pc |

Please consult MODU representative for further information and assistance.

Units: Dimension (mm)

Horizontal Wheel Bends DS2

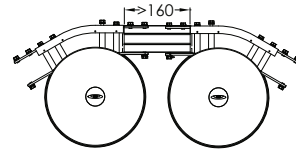

Minimum straight section for all wheel bend connection.

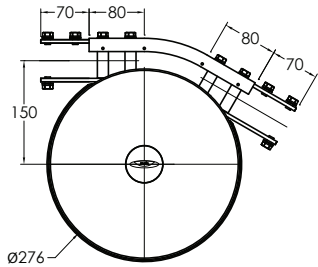

Wheel Bend, 30°

| Item Code | Weight | Supply |
|---------------|--------|--------|
| DS2 BW 30R150 | 2.6 kg | 1 set |

Effective track length:
0.24m 1-way (0.48 m 2-way)
Tolerance: $\pm 2^\circ$
- Connecting strip and screw included.

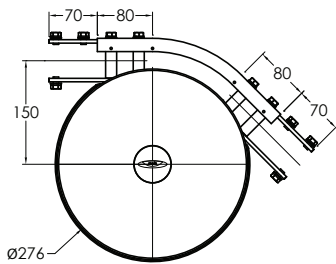

Wheel Bend, 45°

| Item Code | Weight | Supply |
|---------------|--------|--------|
| DS2 BW 45R150 | 2.7 kg | 1 set |

Effective track length:
0.28m 1-way (0.56m 2-way)
Tolerance: $\pm 2^\circ$
- Connecting strip and screw included.

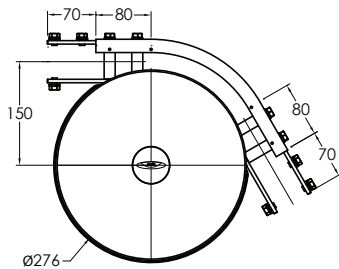

Wheel Bend, 60°

| Item Code | Weight | Supply |
|---------------|--------|--------|
| DS2 BW 60R150 | 2.9 kg | 1 set |

Effective track length:
0.31m 1-way (0.62 m 2-way)
Tolerance: $\pm 2^\circ$
- Connecting strip and screw included.

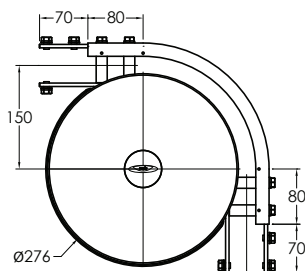

Wheel Bend, 90°

| Item Code | Weight | Supply |
|---------------|--------|--------|
| DS2 BW 90R150 | 3.1 kg | 1 set |

Effective track length:
0.4m 1-way (0.8m 2-way)
Tolerance: $\pm 2^\circ$
- Connecting strip and screw included.

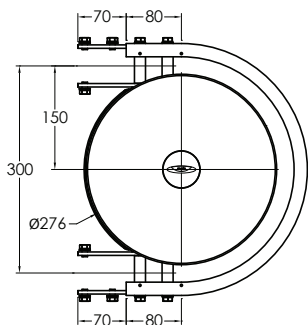

Wheel Bend, 180°

| Item Code | Weight | Supply |
|----------------|--------|--------|
| DS2 BW 180R150 | 3.4 kg | 1 set |

Effective track length:
0.63m 1-way (1.26 m 2-way).
Tolerance: $\pm 2^\circ$
- Connecting strip and screw included.

Please consult MODU representative for further information and assistance.

Units: Dimension (mm)

Horizontal Plain Bends DS2

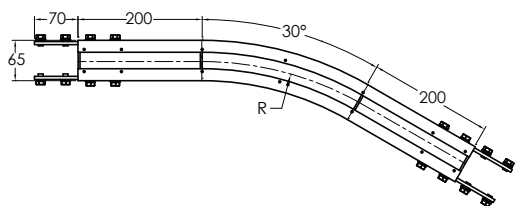

Horizontal Plain Bend, 30°

| Item Code | R | Weight | Supply |
|----------------|---------|--------|--------|
| DS2 BP 30R500 | 500 mm | 2.1 kg | 1 set |
| DS2 BP 30R700 | 700 mm | 2.4 kg | 1 set |
| DS2 BP 30R1000 | 1000 mm | 2.9 kg | 1 set |

Effective track length:

R500: 0.66m 1-way (1.32m 2-way)

R700: 0.77m 1-way (1.54m 2-way)

R1000: 0.92m 1-way (1.84m 2-way).

Tolerance: $\pm 2^\circ$ & Radius: ± 10 mm

- Connecting strip and screw included.

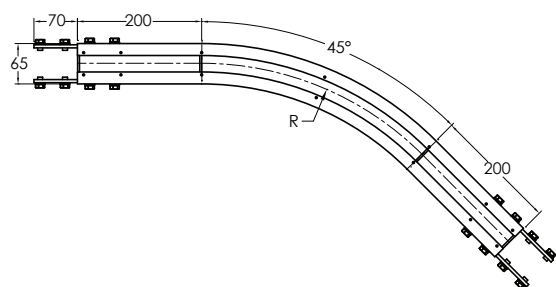

Horizontal Plain Bend, 45°

| Item Code | R | Weight | Supply |
|----------------|---------|--------|--------|
| DS2 BP 45R500 | 500 mm | 2.5 kg | 1 set |
| DS2 BP 45R700 | 700 mm | 3.0 kg | 1 set |
| DS2 BP 45R1000 | 1000 mm | 3.7 kg | 1 set |

Effective track length:

R500: 0.79m 1-way (1.58m 2-way)

R700: 0.95m 1-way (1.90m 2-way)

R1000: 1.12m 1-way (2.40m 2-way)

Tolerance: $\pm 2^\circ$ & Radius: ± 10 mm

- Connecting strip and screw included.

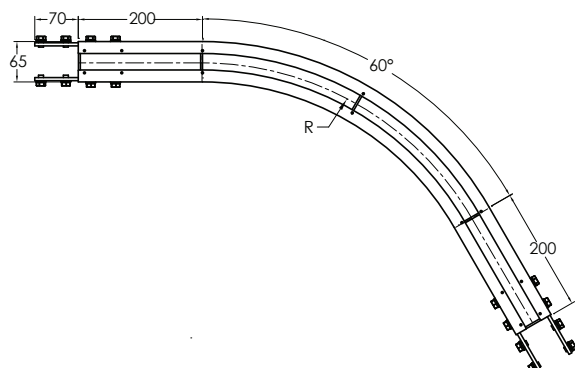

Horizontal Plain Bend, 60°

| Item Code | R | Weight | Supply |
|----------------|---------|--------|--------|
| DS2 BP 60R500 | 500 mm | 2.9 kg | 1 set |
| DS2 BP 60R700 | 700 mm | 3.5 kg | 1 set |
| DS2 BP 60R1000 | 1000 mm | 4.5 kg | 1 set |

Effective track length:

R500: 0.92m 1-way (1.84m 2-way)

R700: 1.13m 1-way (2.26m 2-way)

R1000: 1.45m 1-way (2.90m 2-way)

Tolerance: $\pm 2^\circ$ & Radius: ± 10 mm

- Connecting strip and screw included.

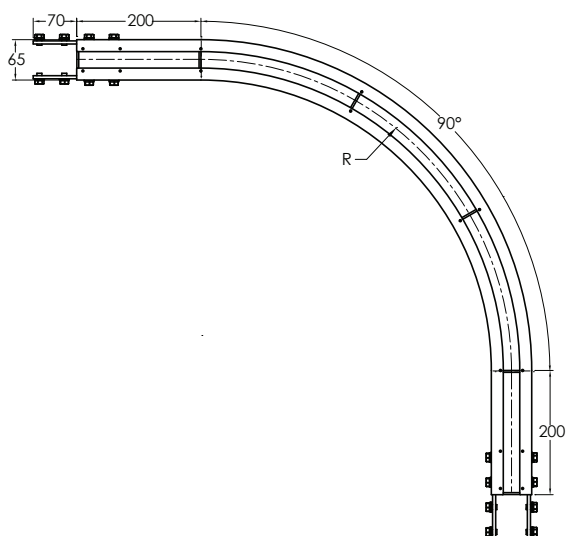

Horizontal Plain Bend, 90°

| Item Code | R | Weight | Supply |
|----------------|---------|--------|--------|
| DS2 BP 90R500 | 500 mm | 3.7 kg | 1 set |
| DS2 BP 90R700 | 700 mm | 4.7 kg | 1 set |
| DS2 BP 90R1000 | 1000 mm | 6.1 kg | 1 set |

Effective track length:

R500: 1.19m 1-way (2.38m 2-way)

R700: 1.50m 1-way (3.00m 2-way)

R1000: 1.97m 1-way (3.94m 2-way)

Tolerance: $\pm 2^\circ$ & Radius: ± 10 mm

- Connecting strip and screw included.

Please consult MODU representative for further information and assistance.

Units: Dimension (mm)

Vertical Bends DS2

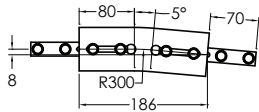

Vertical Bend, 5°

| Item Code | Weight | Supply |
|--------------|--------|--------|
| DS2 BV 5R300 | 0.6 kg | 1 set |

Effective track length:
 R300: 0.19m 1-way (0.38m 2-way)
 Tolerance: $\pm 2^\circ$ & Radius: ± 10 mm
 - Connecting strip and screw included.

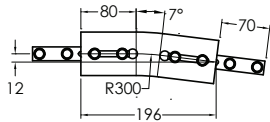

Vertical Bend, 7°

| Item Code | Weight | Supply |
|--------------|--------|--------|
| DS2 BV 7R300 | 0.6 kg | 1 set |

Effective track length:
 R300: 0.20m 1-way (0.40m 2-way)
 Tolerance: $\pm 2^\circ$ & Radius: ± 10 mm
 - Connecting strip and screw included.

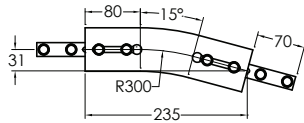

Vertical Bend, 15°

| Item Code | Weight | Supply |
|---------------|--------|--------|
| DS2 BV 15R300 | 0.8 kg | 1 set |

Effective track length:
 R300: 0.24m 1-way (0.48m 2-way)
 Tolerance: $\pm 2^\circ$ & Radius: ± 10 mm
 - Connecting strip and screw included.

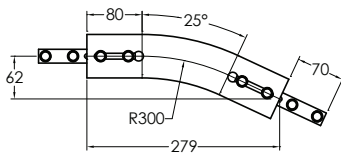

Vertical Bend, 25°

| Item Code | R | A | B | Weight | Supply |
|----------------|---------|--------|--------|--------|--------|
| DS2 BV 25R300 | 300 mm | 62 mm | 279 mm | 0.9 kg | 1 set |
| DS2 BV 25R1000 | 1000 mm | 128 mm | 575 mm | 1.9 kg | 1 set |

Effective track length:
 R300: 0.29m 1-way (0.58m 2-way)
 R1000: 0.60m 1-way (1.20m 2-way)
 Tolerance: $\pm 2^\circ$ & Radius: ± 10 mm
 - Connecting strip and screw included.

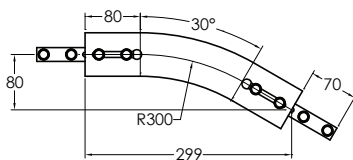

Vertical Bend, 30°

| Item Code | R | A | B | Weight | Supply |
|----------------|---------|--------|--------|--------|--------|
| DS2 BV 30R300 | 300 mm | 80 mm | 299 mm | 1.1 kg | 1 set |
| DS2 BV 30R1000 | 1000 mm | 174 mm | 649 mm | 2.5 kg | 1 set |

Effective track length:
 R300: 0.32m 1-way (0.64m 2-way)
 R1000: 0.68m 1-way (1.36m 2-way)
 Tolerance: $\pm 2^\circ$ & Radius: ± 10 mm
 - Connecting strip and screw included.

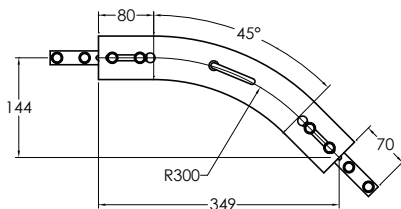

Vertical Bend, 45°

| Item Code | R | A | B | Weight | Supply |
|----------------|---------|--------|--------|--------|--------|
| DS2 BV 45R300 | 300 mm | 145 mm | 349 mm | 1.3 kg | 1 set |
| DS2 BV 45R1000 | 1000 mm | 350 mm | 844 mm | 2.9 kg | 1 set |

Effective track length:
 R300: 0.40m 1-way (0.80m 2-way)
 R1000: 0.95m 1-way (1.90m 2-way)
 Tolerance: $\pm 2^\circ$ & Radius: ± 10 mm
 - Connecting strip and screw included.

Please consult MODU representative for further information and assistance.

Units: Dimension (mm)

Vertical Bends DS2 (Continued)

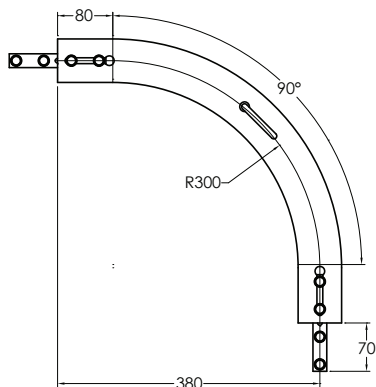

Vertical Bend, 90°

| Item Code | R | B | Weight | Supply |
|----------------|---------|---------|--------|--------|
| DS2 BV 90R300 | 300 mm | 380 mm | 2.0 kg | 1 set |
| DS2 BV 90R1000 | 1000 mm | 1080 mm | 5.4 kg | 1 set |

Effective track length:

R300: 0.63m 1-way (1.26m 2-way)

R1000: 1.73m 1-way (3.46m 2-way)

Tolerance: $\pm 2^\circ$ & Radius: ± 10 mm

- Connecting strip and screw included.

Note:

- Non-Standard Vertical Bend also available in PE and Stainless Steel with minimum radius 300mm.

