

MODU DL2 CONVEYOR SERIES

Technical Characteristics

Chain Width	140 mm
Chain Pitch	44.5 mm
Chain Weight	2.5 kg/m
Chain Working Tension (Max)	
With Wheel Bend	1000 N
Without Wheel Bend	1200 N
Max Product Weight*	
Horizontal Transport	25.0 kg
Vertical Transport	15.0 kg
Total Load*	400 kg
Working Temperature*	-10°C to 60°C
Max Conveyor Length*	30 m
Max speed*	50 m/min
Drive Unit Capacity	1200 N
Item Width*	25 - 320 mm

* Actual limit may vary according to conveyor layout and application.

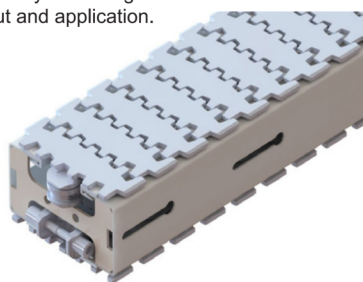

Chain Width 140mm

Contents

Chain ML2	260
Chain Top Replacement ML2	262
Chain Accessories ML2	262
Drive Units DL2	263
Idler End DL2.....	265

Conveyor Beam DL2	266
Accessories DL2.....	266
Horizontal Wheel Bend DL2	267
Horizontal Plain Bend DL2	268
Vertical Bend DL2.....	269

Chain ML2

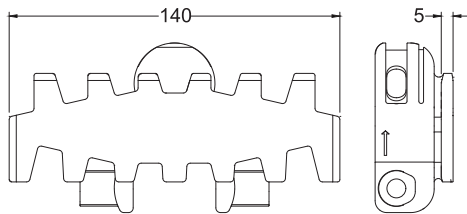

Plain Chain

- Suitable for conveyor configuration with incline/decline up to 7°.
- Accumulation possible.



Item Code	Material	Color	Weight	Supply
ML2 CP 5	POM	White	13.0 kg/roll	5m/roll
ML2 CP 5A	Anti-Static	Yellow	13.0 kg/roll	5m/roll
ML2 CP 5K	Kevlar	Yellow	15.6 kg/roll	5m/roll

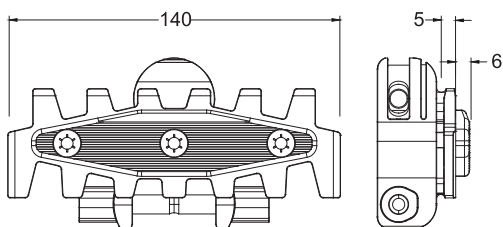

Friction Chain

- Suitable for conveyor configuration with incline/decline up to 25°.
- Friction material : TPE (grey).
- Accumulation not possible



Item Code	Material	Color	Weight	Supply
ML2 CF 5	POM	White	15.0 kg/roll	5m/roll
ML2 CF 5A	Anti-Static	Yellow	15.0 kg/roll	5m/roll
ML2 CF 5K	Kevlar	Yellow	17.0 kg/roll	5m/roll

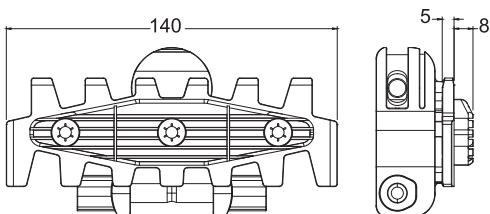

Silicone Pad Friction Chain

- High friction for incline of carton boxes up to 40°
- Accumulation not possible.
- Not suitable to use with Combined Drive



Item Code	Material	Color	Weight	Supply
ML2 CF 3S	POM	White	16.0 kg/roll	3m/roll
ML2 CF 3SA	Anti-Static	Yellow	16.0 kg/roll	3m/roll
ML2 CF 3SK	Kevlar	Yellow	17.0 kg/roll	3m/roll

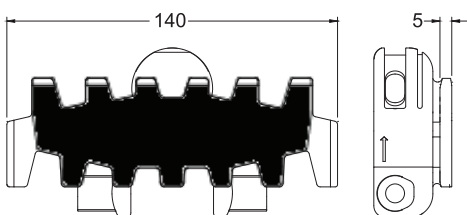

Flocked Chain

- Suitable for scratch sensitive material.
- Flock colour : Black
- Accumulation possible for light product only.
- Sticker type only

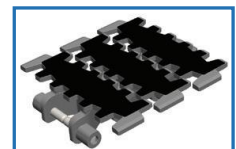

Item Code	Material	Color	Weight	Supply
ML2 CL 5	POM	White	12.5 kg/roll	5m/roll

Please consult MODU representative for further information and assistance.

Units: Dimension (mm)

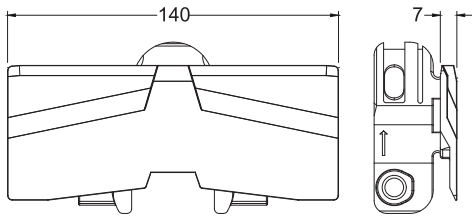

Safety Chain

- Suitable for conveyor configuration with incline/decline up to 5°.
- Accumulation possible.

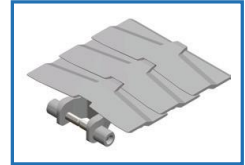

Item Code	Material	Color	Weight	Supply
ML2 CP 5S	POM	White	12.4 kg/roll	5m/roll

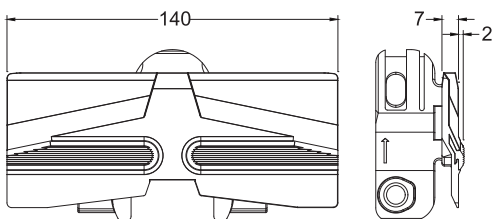

Safety Friction Chain

- Suitable for conveyor configuration with incline/decline up to 25°.
- Friction material : TPE (grey).
- Accumulation not possible
- PP chain material working tension is less than POM, please refer to technical reference



Item Code	Material	Color	Weight	Supply
ML2 CF 5S	PP	White	12.4 kg/roll	5m/roll

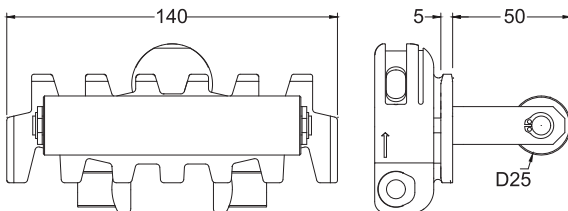

Roller Cleated Link

- Required for vertical or steeply inclined /declined conveyor.
- Accumulation not possible.
- Not suitable to be use with Combined and Catenary Drive.
- Supply in pieces.

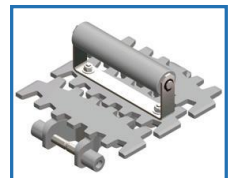

*P
Please specify pitch between cleat for ordering
(eg. ML2 CR 3 4P ; 4P = Every 4rd link to be cleated).

* Non-standard height are available upon request.

Item Code	Material	Color	Weight	Supply
ML2 CR 3 *P	POM	White	** kg/pc	1 pc

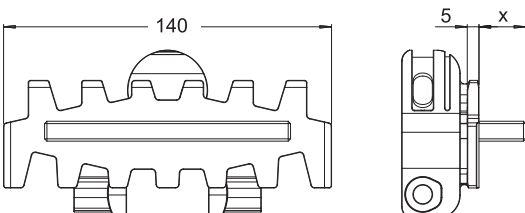

Machined Cleated Link

- Required for vertical or steeply inclined /declined conveyor.
- Accumulation not possible.
- Not suitable to be use with Combined and Catenary Drive.
- Supply in pieces.

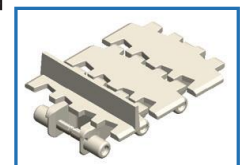

*P
Please specify pitch between cleat for ordering
(eg. ML2 CC 3x15 3P ; 3P = Every 3rd link to be cleated).

Item Code	Material	Color	Weight	Supply
ML2 CC 3X15 *P	POM	White	** kg/pc	1 pc
ML2 CC 3X15A *P	Anti-Static	Yellow	** kg/pc	1 pc
ML2 CC 3X15K *P	Kevlar	Yellow	** kg/pc	1 pc

Please consult MODU representative for further information and assistance.

Units: Dimension (mm)

MODU DL2 SERIES - CHAIN

Chain Top Replacement ML2

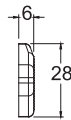
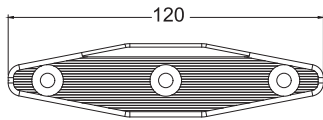

Friction Pad



Item Code	Material	Color	Weight	Supply
ML2 FP 140	TPE	Grey	0.01 kg	10 pcs/pkt

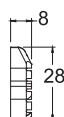
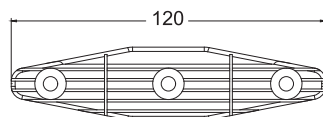

Friction Silicone Pad



Item Code	Material	Color	Weight	Supply
ML2 FP 140S	Silicone	Grey	0.5 kg	10 pcs/pkt

Chain Accessories ML2

Lubricant For Chain



Silicone-based lubricant,
400ml

Item Code	Weight	Supply
MA SL	0.35 kg/can	1 can

Stainless Steel Pin



Item Code	Weight	Supply
ML2 PN M8x73	0.07 kg	10 pcs / pkt

Chain Pivot



Item Code	Weight	Supply
ML2 PV	0.07 kg	10 pcs / pkt

Chain Pin Insertion Tool



Chain pin insertion tool
shown without attachment
and drive pin



Chain attachment and
drive pin

Item Code	Description	Weight	Supply
TR CP 1	Pin Insertion Tool	1.2 kg	1 pc
ML2 AC	Chain Attachment	0.3 kg	1 pc

Please consult MODU representative for further information and assistance.

Units: Dimension (mm)

Drive Units DL2

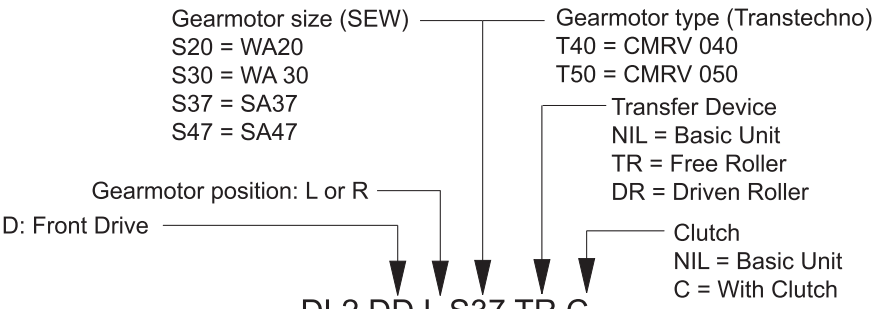

DL2 DD L S37 TR C
Front direct drive unit, motor on left side for 0.55kW SEW geared motor, with Free Roller and Clutch.

Motor Orientation Guideline

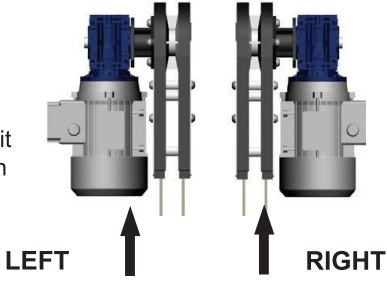

Example. Code for Basic unit;
DL2 DD R S47 => Front drive unit, motor on right side for SEW SA47 gearmotor.

Front Drive Unit

Basic Front Drive

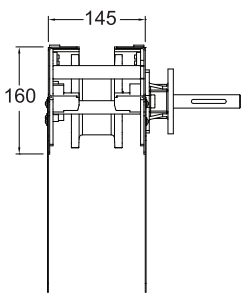
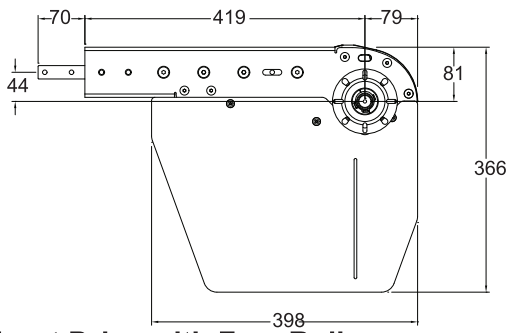

Front Drive with Free Roller

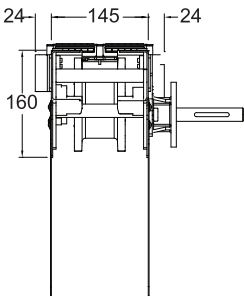
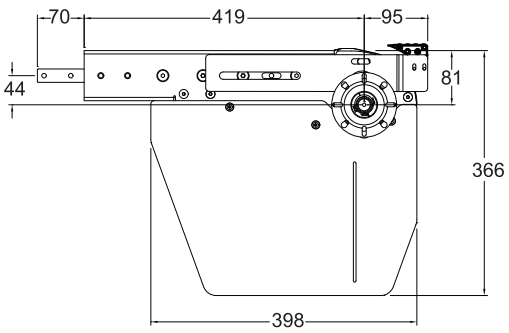

Front Drive with Driven Roller

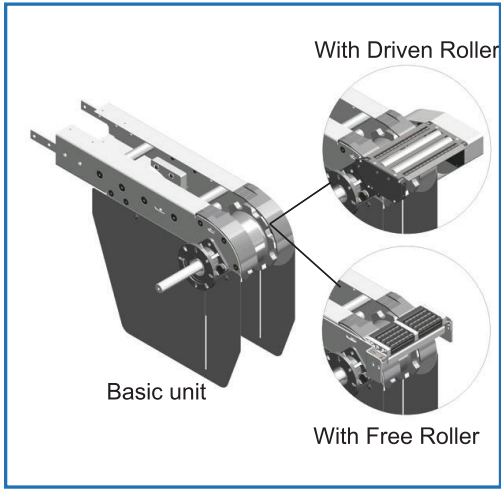
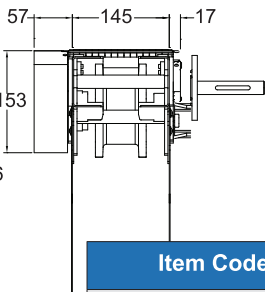
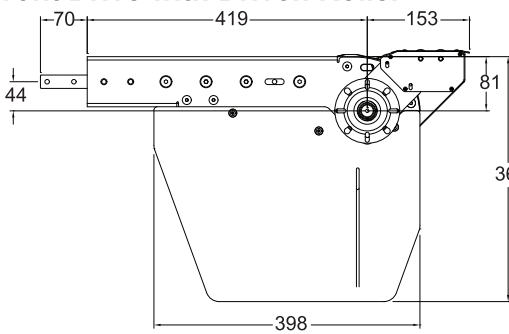

**Comes without safety cover

- Effective track length: 1.16m
 - Traction force: 1200N
 - Connecting strip and M8 hex screw included.
- Note:
- Safety Cover comes as an option.
 - Recommended maximum chain elongation is 328mm from top conveyor to chain slack.

Driven Roller speed is approximately 10% higher than conveyor speed.

Item Code	Description	Weight	Supply
DL2 DD R/L S/T	Basic drive unit	6.4 kg	1 unit
DL2 DD R/L S/T TR	With transfer roller	7.1 kg	1 unit
DL2 DD R/L S/T DR	With driven roller	8.1 kg	1 unit

Please consult MODU representative for further information and assistance. Units: Dimension (mm)

AP

TR

MP

MS3

MM3

ML2

MX2

MT2

MR2

MF2

MPP

MM3P

ML2P

MDP

MG

MB

MA

DS3

DM3

DL2

DX2

DT2

DR2

DF2

DG

DB

DA

SD

SE

TL

IM

MM

MODU DL2 SERIES - DRIVE UNITS

Standard Safety Cover

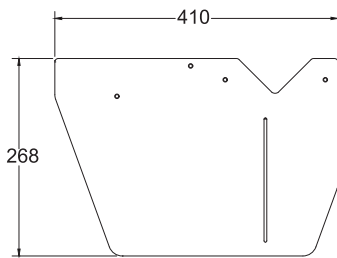

- Material : Stainless Steel
- Suitable to be used with front drive unit and combined drive unit

Item Code	Weight	Supply
SC2 268	1.8 kg	2 pcs/set

Free Transfer Roller

Direct Drive Unit

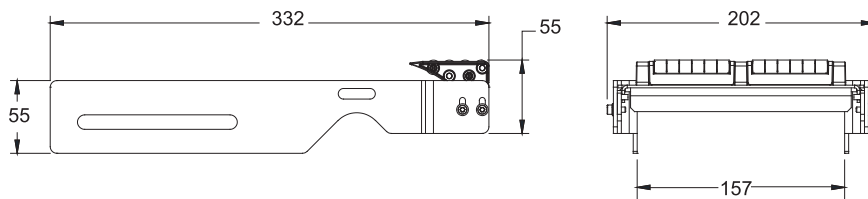

Item Code	Weight	Supply
ML2 TR DD/IE	0.86 kg	1 unit



Combined Drive Unit

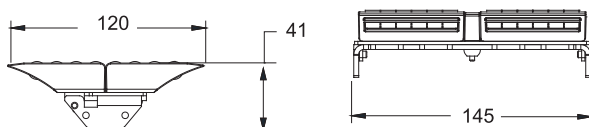

Item Code	Weight	Supply
ML2 TR DT	0.42 kg	1 unit



Please consult MODU representative for further information and assistance.

Units: Dimension (mm)

Idler End DL2

Basic Idler End Unit

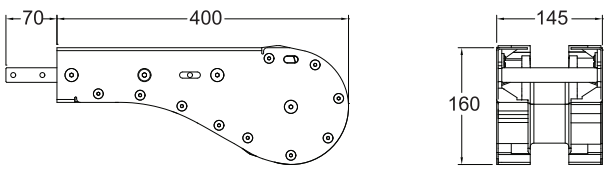

Idler End Unit with Free Roller

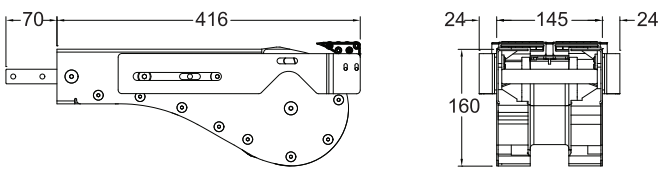

Idler End Unit with Driven Roller

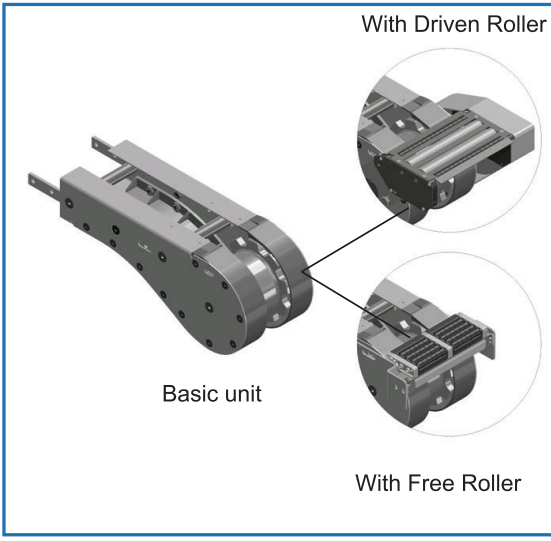
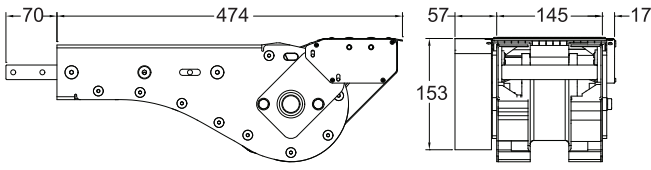

Driven Roller speed is approximately 10% higher than conveyor speed.

- Effective track length: 1.02m
- Connecting strip and M8 hex screw included.

Item Code	Description	Weight	Supply
DL2 IE 400	Basic idler unit	6.7 kg	1 unit
DL2 IE 400 TR	With transfer roller	7.0 kg	1 unit
DL2 IE 400 DR L/R	With driven roller	8.5 kg	1 unit

AP

TR

MP

MS3

MM3

ML2

MX2

MT2

MR2

MF2

MPP

MM3P

ML2P

MDP

MG

MB

MA

DS3

DM3

DL2

DX2

DT2

DR2

DF2

DG

DB

DA

SD

SE

TL

IM

MM

Please consult MODU representative for further information and assistance.

Units: Dimension (mm)

MODU DL2 SERIES - BEAM AND ACCESSORIES

Conveyor Beam DL2

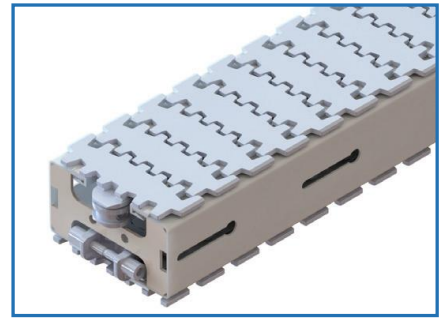
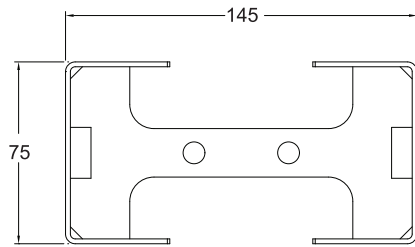

Item Code	Weight	Supply
DL2 CB 2.4	18.9 kg	2.4m / beam
DL2 CB L	**L kg	L / beam

- Available length:
L = between 100, 200mm up 1200mm
- eg: for 200mm beam, part number is DL2 CB 0.2
- if beam required is 1.8m, then L = 1.2m + 0.6m
(order part number = DL2 CB 1.2 & DL2 CB 0.6)

Accessories DL2

Slide Rail

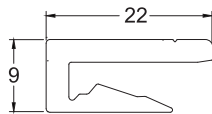

Item Code	Material	Color	Weight	Supply
MA2 SR 25	HDPE	Semi-Transparent White	2.8 kg	25m/roll
MA2 SR 25A	Anti-Static	Grey	2.8 kg	25m/roll
MA2 SR 25U	UHMW-PE	-	-	-

Connecting Strip

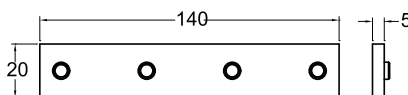

- 4 pcs M8 set screw included.

Item Code	Weight	Supply
DA CS 20x140	1.1 kg	10 pcs/pkt

Screw



Item Code	Weight	Supply
MA RS 6.5	0.02 kg	50 pcs/pkt

Slide Rail Mounting Tool



Item Code	Weight	Supply
MX2 SRA	0.4 kg	1 pc

Please consult MODU representative for further information and assistance.

Units: Dimension (mm)

MODU DL2 SERIES - HORIZONTAL WHEEL BEND

Horizontal Wheel Bend DL2

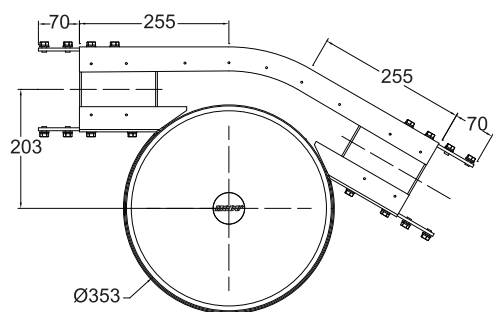

Wheel Bend, 30°

Effective track length:
0.6m 1-way (1.2m 2-way)

- Tolerance: $\pm 2^\circ$ & Radius: $\pm 10\text{mm}$
- Connecting strip and M8 hex screw included.

Item Code	Weight	Supply
DL2 BW 30R200	6.0 kg	1 unit

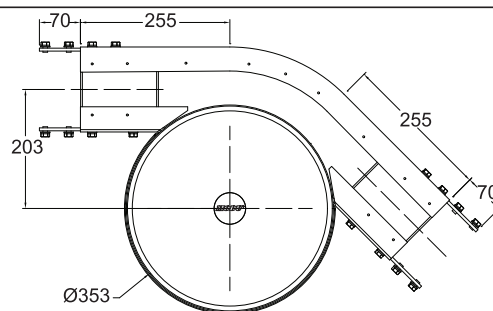

Wheel Bend, 45°

Effective track length:
0.66m 1-way (1.32m 2-way)

- Tolerance: $\pm 2^\circ$ & Radius: $\pm 10\text{mm}$
- Connecting strip and M8 hex screw included.

Item Code	Weight	Supply
DL2 BW 45R200	6.1 kg	1 unit

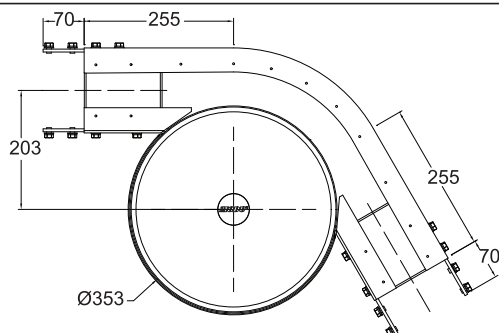

Wheel Bend, 60°

Effective track length:
0.71m 1-way (1.42m 2-way)

- Tolerance: $\pm 2^\circ$ & Radius: $\pm 10\text{mm}$
- Connecting strip and M8 hex screw included.

Item Code	Weight	Supply
DL2 BW 60R200	6.6 kg	1 unit

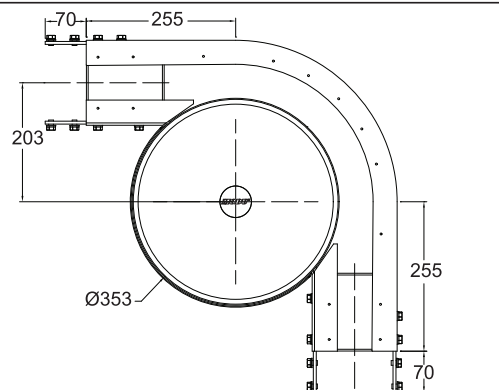

Wheel Bend, 90°

Effective track length:
0.81m 1-way (1.62m 2-way)

- Tolerance: $\pm 2^\circ$ & Radius: $\pm 10\text{mm}$
- Connecting strip and M8 hex screw included.

Item Code	Weight	Supply
DL2 BW 90R200	7.0 kg	1 unit

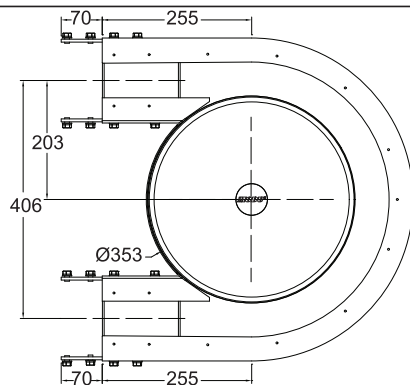

Wheel Bend, 180°

Effective track length:
1.13m 1-way (2.26m 2-way)

- Tolerance: $\pm 2^\circ$ & Radius: $\pm 10\text{mm}$
- Connecting strip and M8 hex screw included.

Item Code	Weight	Supply
DL2 BW 180R200	8.4 kg	1 unit

Please consult MODU representative for further information and assistance.

Units: Dimension (mm)

MODU DL2 SERIES - HORIZONTAL PLAIN BEND

Horizontal Plain Bend DL2

Plain bends comes with options for optimum usage

-With inner slide rail Type A (SA), Material = PE.

-With inner slide rail Type B (SB), Material = Nylon

-With inner slide rail Type N (SN), Material = UHMW-PE

*(SB) is recommended when conveyor speed is 30m/min and above

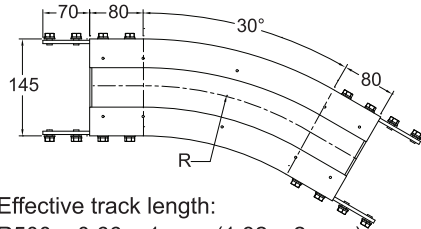
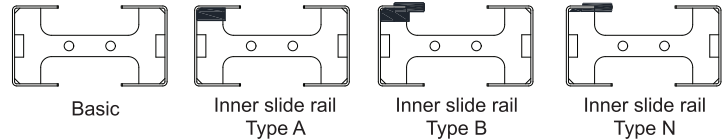

Effective track length:

R500: 0.66m 1-way (1.32m 2-way)

R700: 0.77m 1-way (1.54m 2-way)

R1000: 0.92m 1-way (1.84m 2-way).

Horizontal Plain Bend, 30°

Item Code	Radius (R)	Weight	Supply
DL2 BP 30R500	500 mm	2.2 kg	1 unit
DL2 BP 30R700	700 mm	2.8 kg	1 unit
DL2 BP 30R1000	1000 mm	3.6 kg	1 unit

Tolerance: $\pm 2^\circ$ & Radius: ± 10 mm

- Connecting strip and M8 hex screw included.

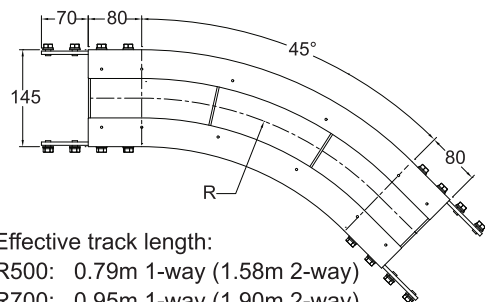

Effective track length:

R500: 0.79m 1-way (1.58m 2-way)

R700: 0.95m 1-way (1.90m 2-way)

R1000: 1.12m 1-way (2.40m 2-way)

Horizontal Plain Bend, 45°

Item Code	Radius (R)	Weight	Supply
DL2 BP 45R500	500 mm	2.9 kg	1 unit
DL2 BP 45R700	700 mm	3.7 kg	1 unit
DL2 BP 45R1000	1000 mm	4.9 kg	1 unit

Tolerance: $\pm 2^\circ$ & Radius: ± 10 mm

- Connecting strip and M8 hex screw included.

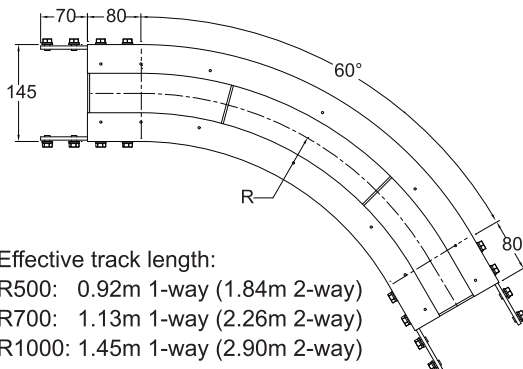

Effective track length:

R500: 0.92m 1-way (1.84m 2-way)

R700: 1.13m 1-way (2.26m 2-way)

R1000: 1.45m 1-way (2.90m 2-way)

Horizontal Plain Bend, 60°

Item Code	Radius (R)	Weight	Supply
DL2 BP 60R500	500 mm	3.6 kg	1 unit
DL2 BP 60R700	700 mm	4.6 kg	1 unit
DL2 BP 60R1000	1000 mm	6.1 kg	1 unit

Tolerance: $\pm 2^\circ$ & Radius: ± 10 mm

- Connecting strip and M8 hex screw included.

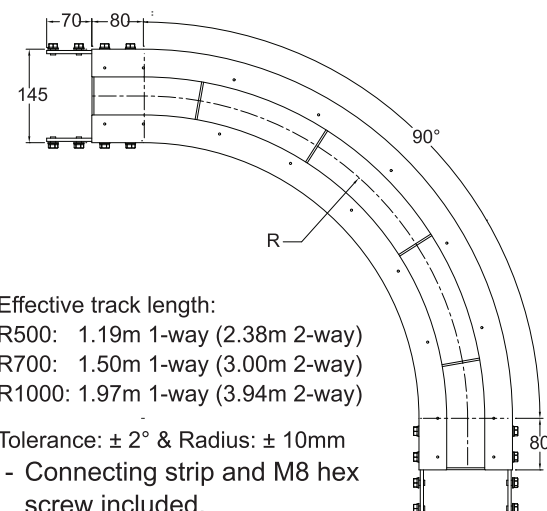

Effective track length:

R500: 1.19m 1-way (2.38m 2-way)

R700: 1.50m 1-way (3.00m 2-way)

R1000: 1.97m 1-way (3.94m 2-way)

Tolerance: $\pm 2^\circ$ & Radius: ± 10 mm

- Connecting strip and M8 hex screw included.

Horizontal Plain Bend, 90°

Item Code	Radius (R)	Weight	Supply
DL2 BP 90R500	500 mm	4.9 kg	1 unit
DL2 BP 90R700	700 mm	6.5 kg	1 unit
DL2 BP 90R1000	1000 mm	8.8 kg	1 unit

When ordering plain bends with inner slide rail, please specify the type using the following part number as an example.

Type A - DL2 BP 30R500 SA

Type B - DL2 BP 90R500 SB

Type N - DL2 BP 90R500 SN

Please consult MODU representative for further information and assistance.

Units: Dimension (mm)

MODU DL2 SERIES - VERTICAL BEND

Vertical Bend DL2

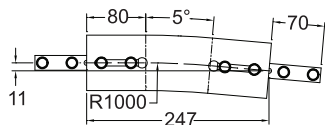

Vertical Bend, 5°

Effective track length:

R1000: 0.25m 1-way (0.5m 2-way)

- Tolerance: $\pm 2^\circ$ & Radius: $\pm 10\text{mm}$
- Connecting strip and M8 hex screw included.

Item Code	Weight	Supply
DL2 BV 5R1000	1.3 kg	1 unit

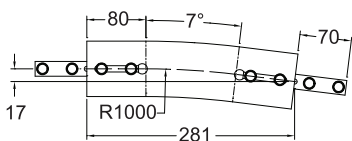

Vertical Bend, 7°

Effective track length:

R1000: 0.28m 1-way (0.56m 2-way)

- Tolerance: $\pm 2^\circ$ & Radius: $\pm 10\text{mm}$
- Connecting strip and M8 hex screw included.

Item Code	Weight	Supply
DL2 BV 7R1000	1.5 kg	1 unit

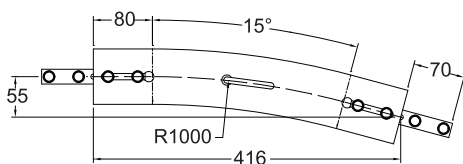

Vertical Bend, 15°

Effective track length:

R1000: 0.42m 1-way (0.84m 2-way)

- Tolerance: $\pm 2^\circ$ & Radius: $\pm 10\text{mm}$
- Connecting strip and M8 hex screw included.

Item Code	Weight	Supply
DL2 BV 15R1000	2.2 kg	1 unit

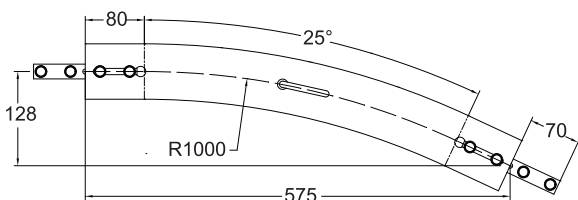

Vertical Bend, 25°

Effective track length:

R1000: 0.60m 1-way (1.20m 2-way)

- Tolerance: $\pm 2^\circ$ & Radius: $\pm 10\text{mm}$
- Connecting strip and M8 hex screw included.

Item Code	Weight	Supply
DL2 BV 25R1000	3.1 kg	1 unit

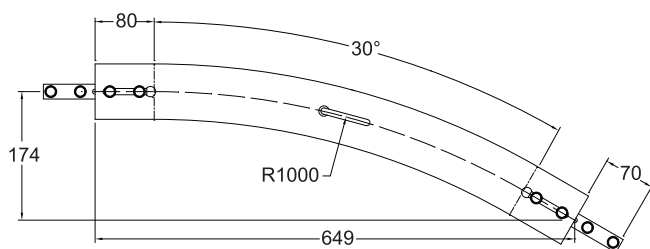

Vertical Bend, 30°

Effective track length:

R1000: 0.68m 1-way (1.36m 2-way)

- Tolerance: $\pm 2^\circ$ & Radius: $\pm 10\text{mm}$
- Connecting strip and M8 hex screw included.

Item Code	Weight	Supply
DL2 BV 30R1000	3.5 kg	1 unit

Please consult MODU representative for further information and assistance.

Units: Dimension (mm)

MODU DL2 SERIES - VERTICAL BEND

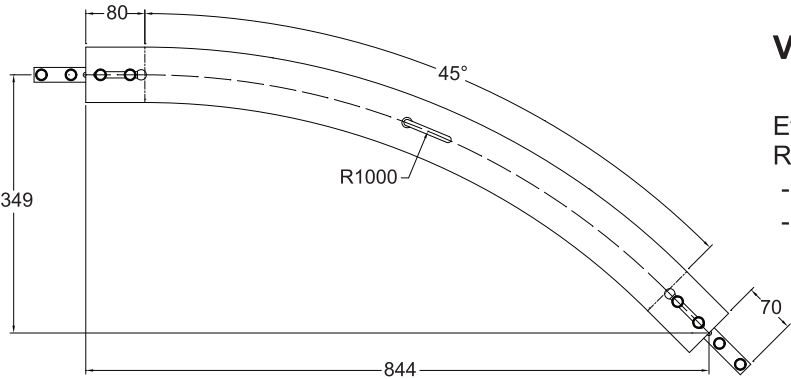

Vertical Bend, 45°

- Effective track length:
R1000: 0.95m 1-way (1.90m 2-way)
- Tolerance: $\pm 2^\circ$ & Radius: $\pm 10\text{mm}$
 - Connecting strip and M8 hex screw included.

Item Code	Weight	Supply
DL2 BV 45R1000	4.8 kg	1 unit

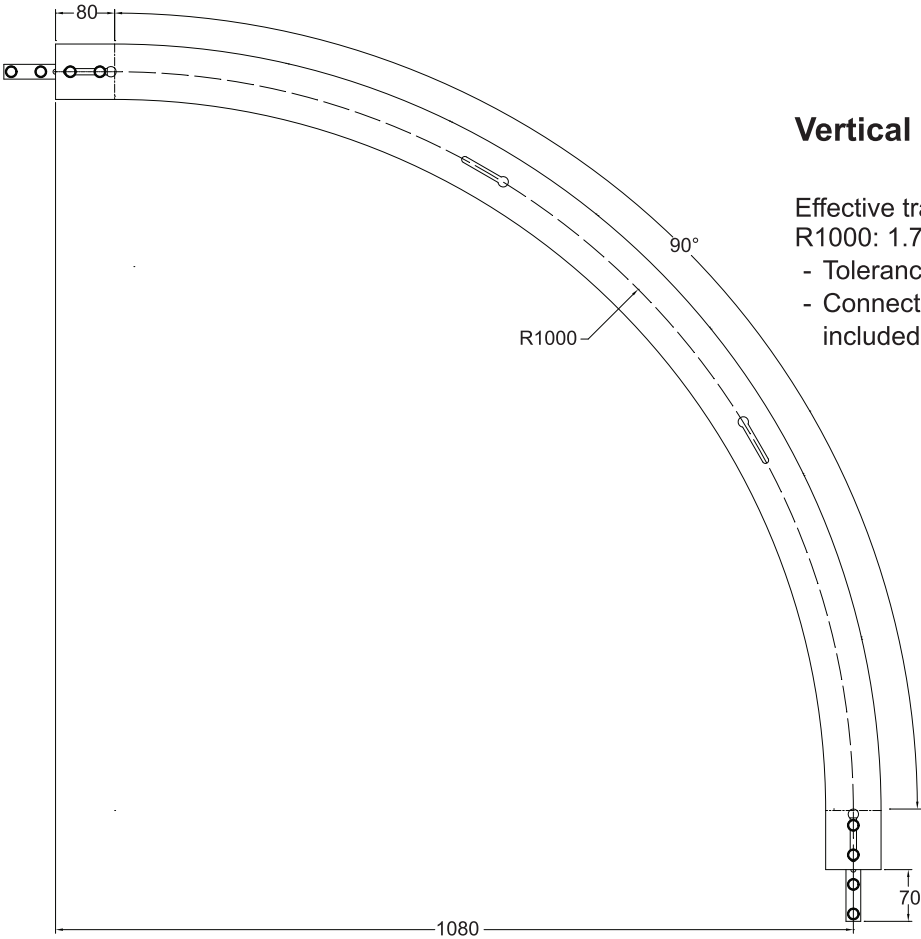

Vertical Bend, 90°

- Effective track length:
R1000: 1.73m 1-way (3.46m 2-way)
- Tolerance: $\pm 2^\circ$ & Radius: $\pm 10\text{mm}$
 - Connecting strip and M8 hex screw included.

Item Code	Weight	Supply
DL2 BV 90R1000	8.8 kg	1 unit

Please consult MODU representative for further information and assistance.

Units: Dimension (mm)